

**Special Use Sensors – Linear Displacement Sensors**

**FEATURES**

- Infinite resolution
- True output linearity over the entire measurement range
- Low operating forces
- Excellent stability and temperature compensation

**DESCRIPTION**

Micro-Measurements Linear Displacement Sensors use a fully active 350-ohm strain-gage bridge to sense spindle displacement, giving infinite resolution and excellent linearity. They are compatible with all standard strain-gage instrumentation with bridge excitation from 2 to 10 volts. With a selection of models having full-scale ranges from 1/4 in (5 mm) to 4 in (100 mm), Linear Displacement Sensors feature a unique design that produces maximum operating forces of less than 1 lb (4.4 N). Available with specially designed mounting fixtures, these versatile sensors are ideally suited for use in research, manufacturing and process control applications.

**ACCURACY**

Micro-Measurements Linear Displacement Sensors produce an output voltage proportional to a captive, guided spindle displacement by means of a 350-ohm strain gage bridge with four active arms. This arrangement provides excellent temperature compensation and linearity.



**COMPATIBILITY**

Micro-Measurements Linear Displacement Sensors exhibit the same inherent advantages for linearity, versatility and precision as many other strain-gage-based sensors. As such, they are systems-compatible with a wide range of commonly used sensors for pressure, load, acceleration, vibration, etc. and normally utilize the same instrumentation.

**OUTLINE DIMENSIONS** in inches (millimeters)

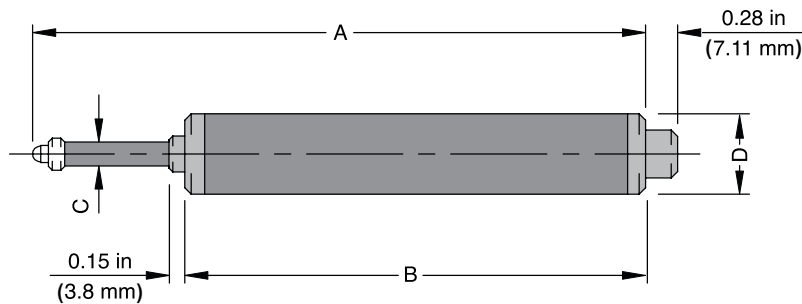

| DIMENSION             | MODEL              |                    |                    |                    |                     |
|-----------------------|--------------------|--------------------|--------------------|--------------------|---------------------|
|                       | HS5                | HS10               | HS25               | HS50               | HS100               |
| <b>A</b>              | 4.10 in (104.2 mm) | 4.30 in (109.2 mm) | 5.44 in (138.2 mm) | 8.48 in (215.4 mm) | 14.97 in (380.2 mm) |
| <b>B</b>              | 3.49 in (88.6 mm)  | 3.49 in (88.6 mm)  | 4.08 in (103.6 mm) | 6.11 in (155.2 mm) | 10.47 in (266.0 mm) |
| <b>C</b> <sub>∅</sub> | 0.19 in (4.8 mm)   | 0.19 in (4.8 mm)   | 0.19 in (4.8 mm)   | 0.19 in (4.8 mm)   | 0.24 in (6.0 mm)    |
| <b>D</b> <sub>∅</sub> | 0.69 in (17.4 mm)  | 0.69 in (17.4 mm)  | 0.69 in (17.4 mm)  | 0.69 in (17.4 mm)  | 1.0 in (25.4 mm)    |

## Special Use Sensors—Linear Displacement Sensors

| <b>SPECIFICATIONS</b>                  |  |                  |                             |                 |                 |
|--|--|------------------|-----------------------------|-----------------|-----------------|
| <b>PARAMETERS</b>                      | <b>MODEL</b>   |                  |                             |                 |                 |
|  | <b>HS5</b>   | <b>HS10</b>      | <b>HS25</b>                 | <b>HS50</b>     | <b>HS100</b>    |
| <b>Displacement Range*</b>             | 0.25 in (6.5 mm)   | 0.5 in (11.2 mm) | 1 in (26 mm)                | 2 in (51.5 mm)  | 4 in (102 mm)   |
| <b>Weight</b>                          | 0.31 lb (140 g)  | 0.31 lb (140 g)  | 0.33 lb (150 g)             | 0.44 lb (200 g) | 1.10 lb (500 g) |
| <b>Spring Force*</b>                   | 0.44 lb (200 g)  | 0.55 lb (250 g)  | 0.55 lb (250 g)             | 0.66 lb (300 g) | 0.77 lb (350 g) |
| <b>Excitation</b>                      | 2 to 10 V, AC or DC  |                  |                             |                 |                 |
| <b>Frequency Response*</b>             | 5-mm displacement: 100 Hz; 100-mm displacement: 10 Hz                        |                  |                             |                 |                 |
| <b>Rated (F.S.) Output*</b>            | 4.5 mV/V   | 5.3 mV/V         | 7.0 mV/V                    | 3.6 mV/V        | 5.2 mV/V        |
| <b>Nonlinearity (Best-Fit Method)*</b> | 0.35% FS   | 0.35% FS         | 0.35% FS                    | 0.35% FS        | 0.35% FS        |
| <b>Resolution</b>                      | Infinite   |                  |                             |                 |                 |
| <b>Bridge Resistance (Nominal)</b>     | 350 ohms bridge, 100k ohms zero balance                                      |                  |                             |                 |                 |
| <b>Temperature Range</b>               | +15 to +140°F (-10 to +60°C)   |                  |                             |                 |                 |
| <b>Temperature Coefficient (%FS)*</b>  | Zero <0.006%/°F (<0.01%/°C)  |                  | Span <0.006%/°F (<0.01%/°C) |                 |                 |
| <b>Termination</b>                     | 0.18 in PVC 7/0.008 (4.5 mm PVC 7/0.2), 4-core shielded, 6.6 ft (2.2 m) long |                  |                             |                 |                 |
| <b>Electrical Connections</b>          | Input: Red+ Black- ; Output: Green+ White-                                   |                  |                             |                 |                 |

\* Typical figures: actual values subject to calibration

| <b>FATIGUE LIFE</b>                |                             |             |             |             |             |
|------------------------------------|-----------------------------|-------------|-------------|-------------|-------------|
| <b>MODEL</b>                       | <b>DISPLACEMENT (NCHES)</b> |             |             |             |             |
|                                    | <b>0.25</b>                 | <b>0.50</b> | <b>1.00</b> | <b>2.00</b> | <b>4.00</b> |
| <b>Cycles to Failure (Nominal)</b> |                             |             |             |             |             |
| <b>HS5</b>                         | 5.00E+04                    |             |             |             |             |
| <b>HS10</b>                        | 5.00E+05                    | 5.00E+04    |             |             |             |
| <b>HS25</b>                        | 5.00E+06                    | 5.00E+05    | 5.00E+04    |             |             |
| <b>HS50</b>                        | 5.00E+06                    | 5.00E+06    | 5.00E+06    | 5.00E+05    |             |
| <b>HS100</b>                       | 5.00E+06                    | 5.00E+06    | 5.00E+06    | 5.00E+05    | 5.00E+04    |
| <b>Signal (mV/V)</b>               |                             |             |             |             |             |
| <b>HS5</b>                         | 4.50                        |             |             |             |             |
| <b>HS10</b>                        | 2.65                        | 5.30        |             |             |             |
| <b>HS25</b>                        | 1.75                        | 3.50        | 7.00        |             |             |
| <b>HS50</b>                        | 0.45                        | 0.90        | 1.80        | 3.60        |             |
| <b>HS100</b>                       | 0.32                        | 0.65        | 1.30        | 2.60        | 5.20        |

\* Please note that recommended displacements are indicated by shading



## Disclaimer

ALL PRODUCTS, PRODUCT SPECIFICATIONS AND DATA ARE SUBJECT TO CHANGE WITHOUT NOTICE.

Vishay Precision Group, Inc., its affiliates, agents, and employees, and all persons acting on its or their behalf (collectively, "VPG"), disclaim any and all liability for any errors, inaccuracies or incompleteness contained herein or in any other disclosure relating to any product.

The product specifications do not expand or otherwise modify VPG's terms and conditions of purchase, including but not limited to, the warranty expressed therein.

VPG makes no warranty, representation or guarantee other than as set forth in the terms and conditions of purchase. **To the maximum extent permitted by applicable law, VPG disclaims (i) any and all liability arising out of the application or use of any product, (ii) any and all liability, including without limitation special, consequential or incidental damages, and (iii) any and all implied warranties, including warranties of fitness for particular purpose, non-infringement and merchantability.**

Information provided in datasheets and/or specifications may vary from actual results in different applications and performance may vary over time. Statements regarding the suitability of products for certain types of applications are based on VPG's knowledge of typical requirements that are often placed on VPG products. It is the customer's responsibility to validate that a particular product with the properties described in the product specification is suitable for use in a particular application. You should ensure you have the current version of the relevant information by contacting VPG prior to performing installation or use of the product, such as on our website at [vpgsensors.com](http://vpgsensors.com).

No license, express, implied, or otherwise, to any intellectual property rights is granted by this document, or by any conduct of VPG.

The products shown herein are not designed for use in life-saving or life-sustaining applications unless otherwise expressly indicated. Customers using or selling VPG products not expressly indicated for use in such applications do so entirely at their own risk and agree to fully indemnify VPG for any damages arising or resulting from such use or sale. Please contact authorized VPG personnel to obtain written terms and conditions regarding products designed for such applications.

Product names and markings noted herein may be trademarks of their respective owners.

Copyright Vishay Precision Group, Inc., 2014. All rights reserved.