

# C&K 1000 Series Miniature Slide Switches

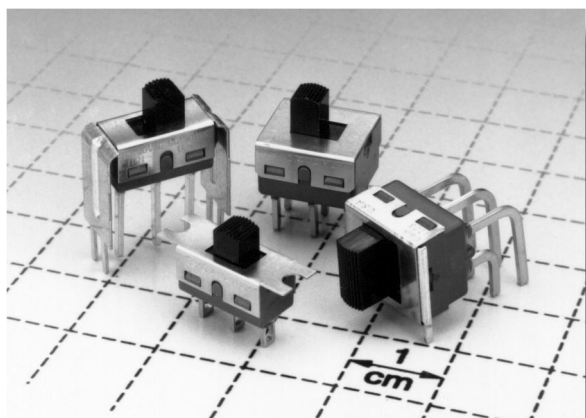

## Features/Benefits

- Variety of actuators and terminations
- Panel mount tabs available
- Epoxy terminal seal—compatible with bottom-wash cleaning



## Typical Applications

- Test & measurement equipment
- Telecommunications
- Computer & peripherals

## Build-A-Switch

Our easy Build-A-Switch concept allows you to mix and match options to create the switch you need. Below is a complete listing of options shown in catalog. To order, simply select desired option from each category and place in the appropriate box. Switches with standard options are shown on page E-11. Available options are shown and described on pages E-12 thru E-15. For additional options not shown in catalog, consult Customer Service Center. All models have epoxy terminal seal and are compatible with all "bottom-wash" PCB cleaning methods.

Typical Example: 1 1 0 1 — M 2 — S 3 — Z     — Q — E — 2

### Switch Function

- 1101 (STD.) SP On-None-On**
- 1103** SP On-Off-On
- 1108** SP Mom.-None-On
- 1201** DP On-None-On
- 1203** DP On-Off-On

### Mounting Style

- M2 (STD.) PC mount without tabs**
- M1** Panel mount with tabs

### Actuator

- S3 (STD.) .200" high**
- S1** .040" high
- S2** .140" high
- S4** .285" high
- S5** .370" high
- S6** .485" high
- T3** .200" high

### Terminations

- A (STD.) Right angle, PC thru-hole**
- C (STD.) PC Thru-hole**
- AV2 (STD.) Vertical right angle, PC thru-hole**
- Z (STD.) Solder lug**
- AW** Right angle, extended, PC thru-hole
- AW1** Right angle, extended, PC thru-hole
- V3** V-bracket
- V4** V-bracket
- W** .750" long, wire wrap
- W3** .425" long, wire wrap
- Z3** Quick connect

### Contact Material

- B (STD.) Gold**
- Q (STD.) Silver**
- K** Gold
- M** Silver
- G** Gold over silver
- L** Gold over silver

### Seal

- E (STD.) Epoxy**
- I** Epoxy potted base

### Actuator Color

- 2 (STD.) Black**
- 1** White
- 3** Red

## Specifications

**CONTACT RATING:** B contact material: 0.4 VA max. @ 20 V AC or DC max. Q contact material: 6 AMPS @ 120 V AC or 28 V DC, 3 AMPS @ 250 V AC. See page E-15 for additional ratings.

**ELECTRICAL LIFE:** 100,000 make-and-break cycles at full load on models with B or K contact material; 40,000 cycles on models with G, Q, L or M contact material.

**CONTACT RESISTANCE:** Below 10 milliohms typ. initial @ 2-4 V DC, 100 mA, for both silver and gold plated contacts.

**INSULATION RESISTANCE:** 10<sup>9</sup> ohms min.

**DIELECTRIC STRENGTH:** 1,000 V RMS min. @ sea level.

**OPERATING TEMPERATURE:** -30°C to 65°C

**SOLDERABILITY:** Per MIL-STD-202F method 208D, or EIA RS-186E method 9 (1 hour steam aging).

## Materials

**CASE:** diallyl phthalate (DAP), (UL 94V-0).

**ACTUATOR:** Nylon, black, standard.

**HOUSING:** Stainless steel.

**SWITCH SUPPORT:** Brass or steel, tin plated.

**END CONTACTS:** B contact material: Copper alloy, with gold plate over nickel plate. Q contact material: Coin silver, silver plated. See page E-15 for additional contact materials.

**CENTER CONTACT & ALL TERMINALS:** B contact material: Copper alloy, with gold plate over nickel plate. Q contact material: Copper alloy, silver plated. See page E-15 for additional contact materials.

**TERMINAL SEAL:** Epoxy

**NOTE:** Specifications and materials listed above are for switches with standard options. For information on specific and custom switches, consult Customer Service Center.

# C&K 1000 Series Miniature Slide Switches

## SWITCHES WITH STANDARD OPTIONS

PART NUMBER	FUNCTION	POS. 1	POS. 2	POS. 3
		<b>1101M2S3CQE2</b>	SPDT	ON

NOTE: For PC mounting information, see page E-13.

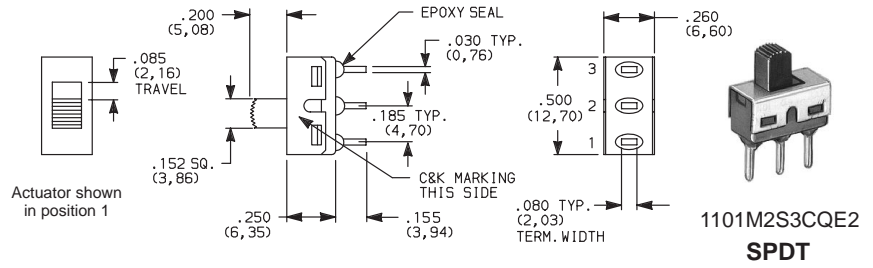

PART NUMBER	FUNCTION	POS. 1	POS. 2	POS. 3
		<b>1201M2S3CQE2</b>	DPDT	ON

NOTE: For PC mounting information, see page E-13.

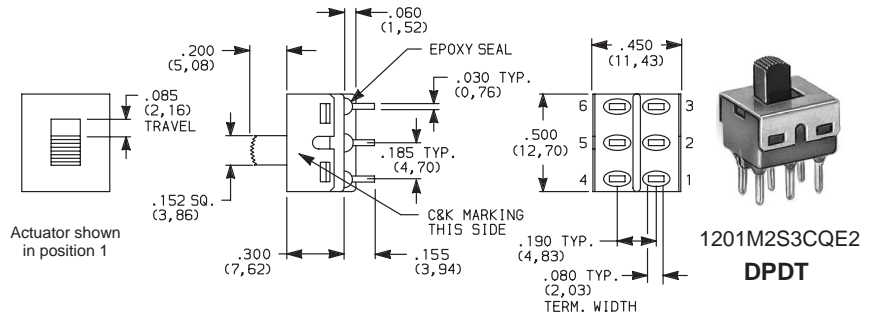

PART NUMBER	FUNCTION	POS. 1	POS. 2	POS. 3
		<b>1101M2S3V3BE2</b>	SPDT	ON

NOTE: For PC mounting information, see page E-15.

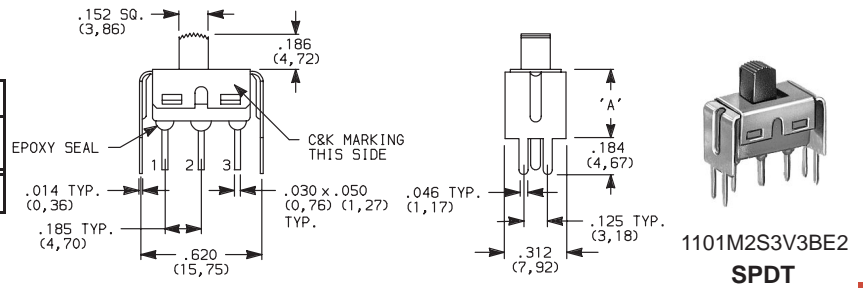

PART NUMBER	FUNCTION	POS. 1	POS. 2	POS. 3
		<b>1101M2S3AQE2</b>	SPDT	ON

NOTE: For PC mounting information, see page E-13.

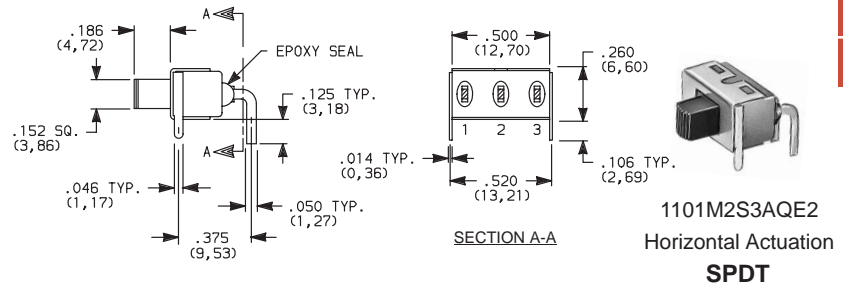

PART NUMBER	FUNCTION	POS. 1	POS. 2	POS. 3
		<b>1101M2S3AV2BE2</b>	SPDT	ON

NOTE: For PC mounting information, see page E-14.

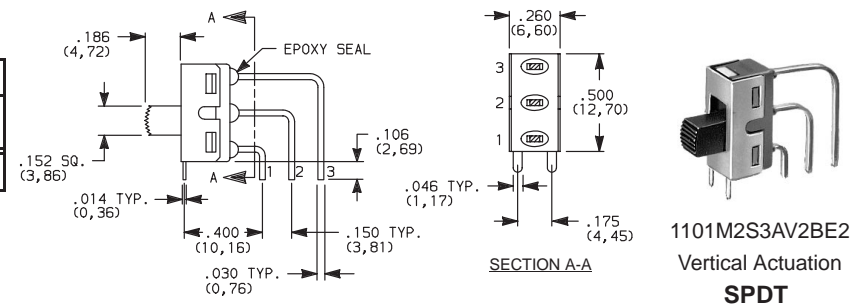

# C&K 1000 Series Miniature Slide Switches

## SWITCH FUNCTION

NO. POLES	MODEL NO.	SWITCH FUNCTION			CONNECTED TERMINALS			SCHEMATIC
		POS. 1	POS. 2	POS. 3	POS. 1	POS. 2	POS. 3	
SP	1101 (STD.)	ON	NONE	ON	1-2	OPEN	2-3	
	1103	ON	OFF	ON				
	1108	ON	NONE	MOM.				
DP	1201	ON	NONE	ON	2-1,5-4	OPEN	2-3,5-6	
	1203	ON	OFF	ON				

MOM. = Momentary

All models with all options when ordered with G, L, M or Q contact material.

## MOUNTING STYLE

### M2 (STD.) PC MOUNTING WITHOUT TABS

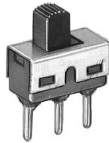

NOTE: Available with A, AV2, AW, AW1, C, V3, V4, W, W3 terminations only.

### M1 PANEL MOUNTING WITH TABS

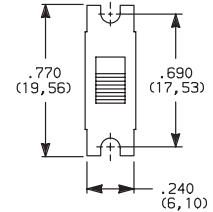
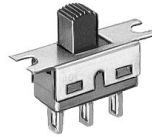

NOTE: Available with C, W, W3, Z, Z3 terminations only. No mounting hardware supplied.

### PANEL MOUNTING

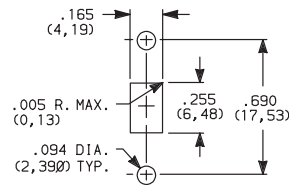

All actuators except T3.

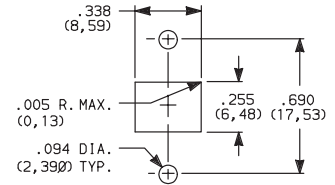

For T3 actuator only.

## ACTUATOR

### S3 (STD.) .200" HIGH

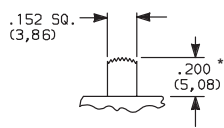

### S2 .140" HIGH

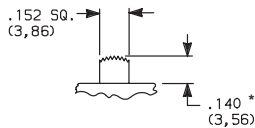

110X models only.

### S1 .040" HIGH

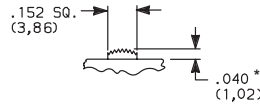

120X models only.

### S4 .285" HIGH

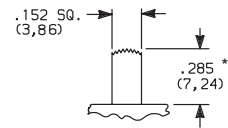

### S5 .370" HIGH

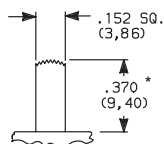

### S6 .485" HIGH

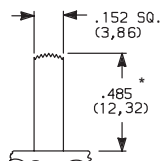

### T3 .200" HIGH

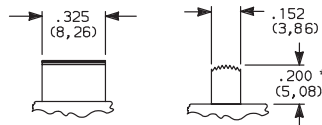

120X models only.

OPTION CODE	ACTUATOR COLOR
2	(STD.) BLACK
1	WHITE
3	RED

Other colors available, consult Customer Service Center.

\* Subtract .014 (0,36) from actuator height, all models with A, AV2, AW, AW1, V3, V4 terminations.

# C&K 1000 Series Miniature Slide Switches

## TERMINATIONS

### Z (STD.) SOLDER LUG

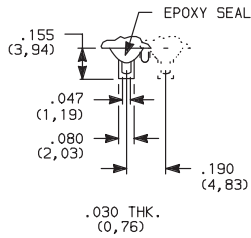

### C (STD.) PC THRU-HOLE

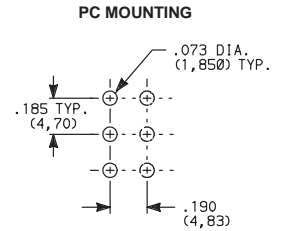
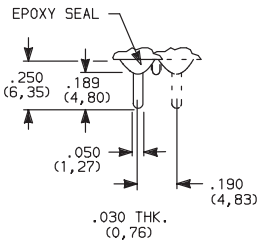

### SPDT & DPDT

Not available with K, L or M contact materials.

### SPDT & DPDT

### Z3 QUICK CONNECT

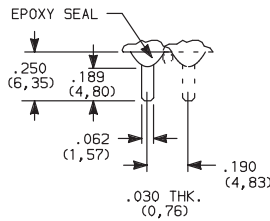

### W, W3 WIRE WRAP

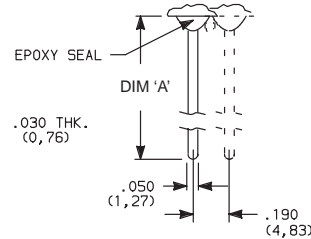

OPTION CODE	DIM 'A'
W	.750 (19,05)
W3	.425 (10,80)

### SPDT & DPDT

Not available with K, L or M contact materials. Mating quick connector available; order part number 530100000.

### SPDT & DPDT

### A (STD.) RIGHT ANGLE, PC THRU-HOLE

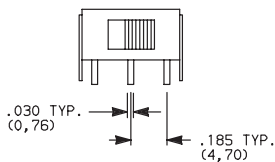

Actuator Shown In Pos. 1

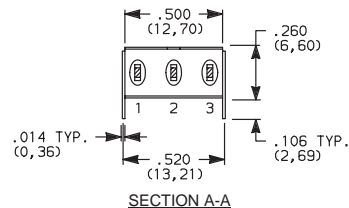
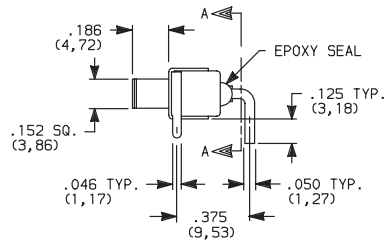

1101M2S3ABE2  
Horizontal Actuation  
SPDT

### AW, AW1 RIGHT ANGLE, EXTENDED, PC THRU-HOLE

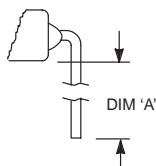

OPTION CODE	DIM 'A'
AW	.50 (12,7)
AW1	.71 (18,0)

### PC MOUNTING

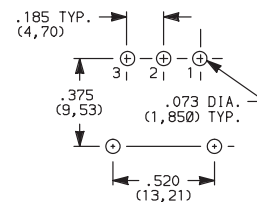

Not available with M1 mounting style, I seal option.  
Terminal bend radii and lead-in manufacturing option.

# C&K 1000 Series Miniature Slide Switches

## TERMINATIONS

### A (STD.) RIGHT ANGLE, PC THRU-HOLE



**1201M2S3ABE2**  
Horizontal Actuation  
**DPDT**

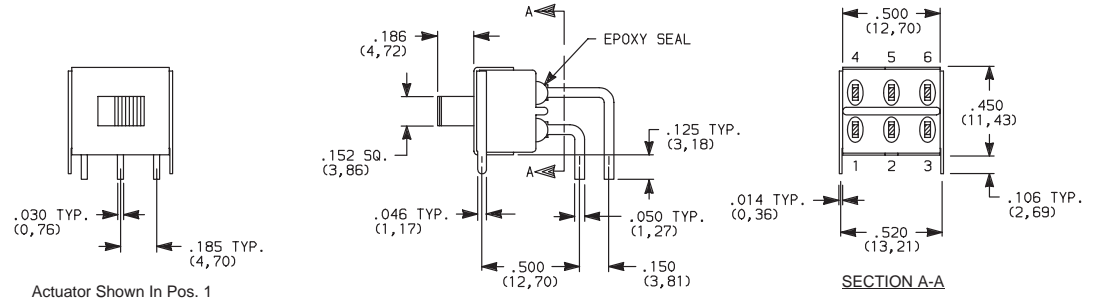

### AW1 RIGHT ANGLE, EXTENDED, PC THRU-HOLE

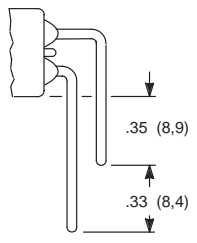

#### PC MOUNTING

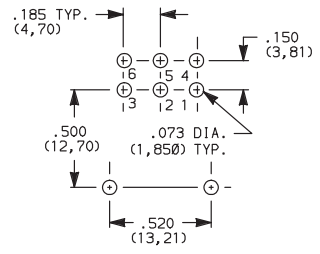

Not available with M1 mounting style, I seal option.  
Terminal bend radii and lead-in manufacturing option.

### AV2 (STD.) VERTICAL RIGHT ANGLE, PC THRU-HOLE, .150" PITCH



**1101M2S3AV2BE2**  
Vertical Actuation  
**SPDT**

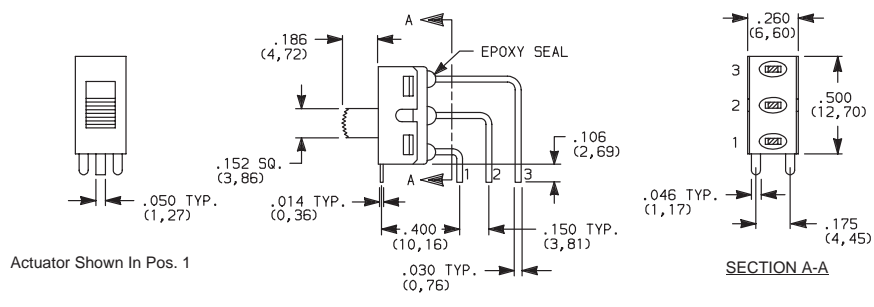

#### PC MOUNTING

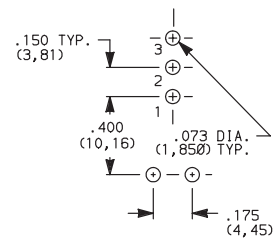

Not available with M1 mounting style, I seal option.  
Terminal bend radii and lead-in manufacturing option.

### AV2 (STD.) VERTICAL RIGHT ANGLE, PC THRU-HOLE, .150" PITCH



**1201M2S3AV2BE2**  
Vertical Actuation  
**DPDT**

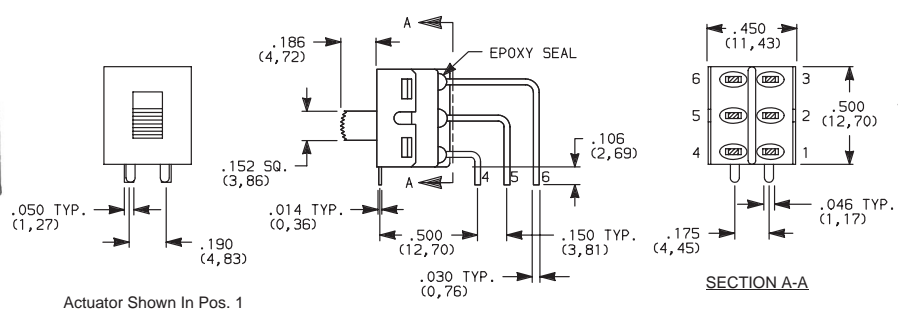

#### PC MOUNTING

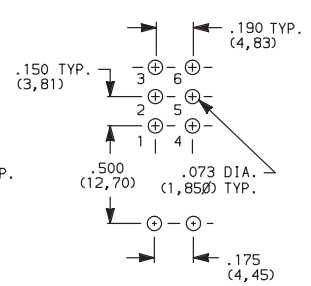

Not available with M1 mounting style, I seal option.  
Terminal bend radii and lead-in manufacturing option.

Slide

## TERMINATIONS

**V3, V4** VERTICAL MOUNT,  
V-BRACKET

OPTION CODE	DIM 'A'
<b>V3</b>	.350 (8,89)
<b>V4</b>	.525 (13,34)

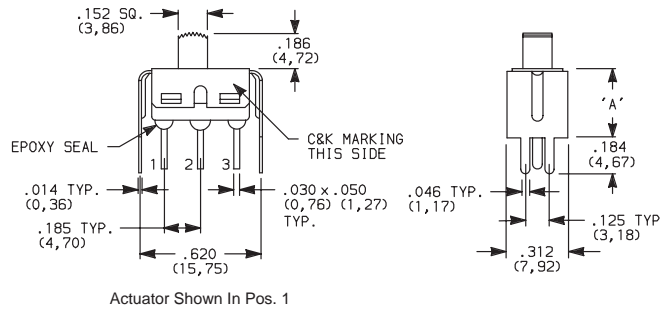

PC MOUNTING

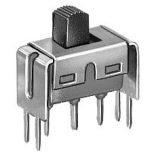
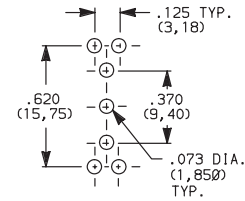

1101M2S3\_BE2  
SPDT

Not available with  
M1 mounting style and I seal.

**V3, V4** VERTICAL MOUNT,  
V-BRACKET

OPTION CODE	DIM 'A'
<b>V3</b>	.400 (10,16)
<b>V4</b>	.575 (14,61)

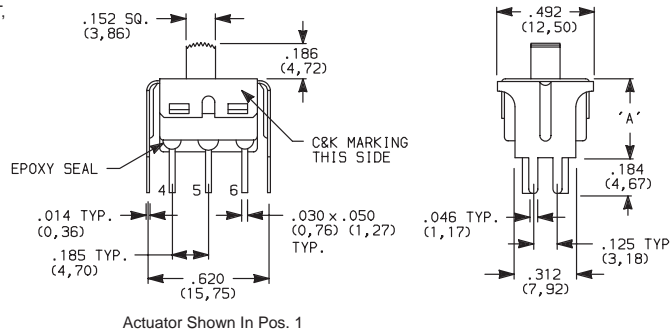

PC MOUNTING

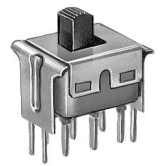
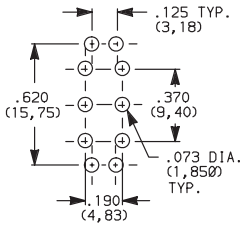

1201M2S3\_BE2  
DPDT

Not available with  
M1 mounting style and I seal.

## CONTACT MATERIAL

OPTION CODE	CONTACT MATERIAL	TERMINAL PLATING	RATINGS	
<b>B (STD.)</b>	GOLD <sup>1</sup>	GOLD <sup>1</sup>	LOW LEVEL/DRY CIRCUIT	0.4 VA MAX. @ 20 V AC OR DC MAX.
<b>K</b>		TIN-LEAD <sup>6</sup>		
<b>Q (STD.)</b>	SILVER <sup>4,5</sup>	SILVER <sup>5</sup>	POWER	6 AMPS @ 120 V AC OR 28 V DC; 3 AMPS @ 250 V AC.
<b>M</b>		TIN-LEAD <sup>6</sup>		
<b>G</b>	GOLD OVER SILVER <sup>2,3</sup>	GOLD <sup>3</sup>	LOW LEVEL/DRY CIRCUIT OR POWER	0.4 VA MAX @ 20 V AC OR DC MAX. OR 6 AMPS @ 120 V AC OR 28 V DC; 3 AMPS @ 250 V AC.
<b>L</b>		TIN-LEAD <sup>6</sup>		

CONTACT MATERIAL/APPLICATION RECOMMENDATIONS—SEE CHART, PAGE L-31.

- CONTACTS & TERMINALS: Copper alloy, with gold plate over nickel plate.
- END CONTACTS: Coin silver, with gold plate over nickel plate.
- CENTER CONTACTS & ALL TERMINALS: Copper alloy, with gold plate over nickel plate.
- END CONTACTS: Coin silver, silver plated.
- CENTER CONTACT & ALL TERMINALS: Copper alloy, silver plated.
- TERMINALS: Copper alloy, with tin-lead alloy over nickel plate.

All models with all options when ordered with G, L, M or Q contact material.  
B contact material standard with all terminations except C, Z, Z3.  
Q contact material standard with C, Z, Z3 terminations.  
**K, L, M contact materials not available with Z, Z3 terminations.**

## SEAL

**E (STD.)** EPOXY SEAL

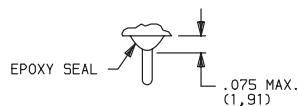

**I** EPOXY POTTED BASE

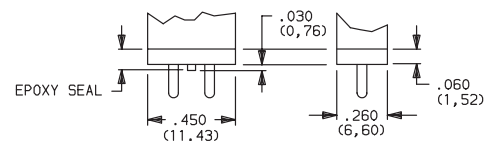

LENGTH IS SAME AS SWITCH BODY

**NOTE:** Available with C, W, W3, Z, Z3 terminations only.