

## Dual Swivel Saddle Spacer

### DSWS4

These saddle spacers are installed between two bundles (such as wires, cables, hoses, tubing, conduit, etc.) to separate them and prevent chafing and wear. The mounts can be easily rotated by hand, allowing the bundles to be crossed and rotated at any angle. Cable ties, which secure the bundles, are used with the mounts. The dual swivel saddle spacers accommodate cable ties up to 1/2" wide.

The "H" profile of the saddles allows for broad surface contact with the bundle, minimizing pinching and crushing of the bundle, and it accepts a wide range of bundle diameters from .25 inches to 3 inches.

The DSWS4 Dual Swivel Saddle Spacer provides a .7 inch (17.8 millimeter) separation between bundles. Friction tabs in the tie slots help hold the cable ties in place during assembly.

The DSWS4 is two-shot molded with polyacetal and polyamide 6.6 heat stabilized materials.



Material Data	
Material	<b>Polyacetal (POM)</b>
Operating Temperature	<b>-40 °F to +185 °F (-40 °C to +85 °C) continuous</b>
Flammability	<b>UL94 HB</b>

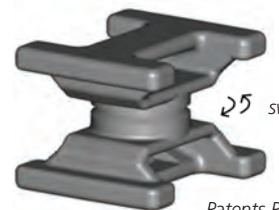

↻ swivels

Patents Pending

Material Data	
Material	<b>Polyamide 6.6 heat stabilized (PA66HS)</b>
Operating Temperature	<b>-40 °F to +221 °F (-40 °C to +105 °C) continuous</b>
Flammability	<b>UL94 V2</b>

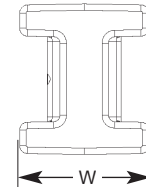
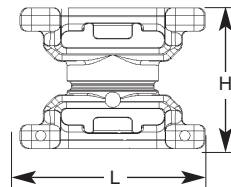

### Product Selection

Article No.	Part No.	Type	Cable Tie Series	Bundle Ø	Minimum Extraction Strength	Length (L)	Width (W)	Height (H)	Color	Pkg. Qty.
				in. (mm)	lb. (N)	in. (mm)	in. (mm)	in. (mm)		
151-06500	<b>151-06500</b>	DSWS4	T50 - T250	.25" - 3" (6.35 - 76.2)	100 lb. (445)	.93" (23.6)	.8" (20.3)	.71" (18)	Black	2200
151-00644	<b>151-00644</b>	DSWS4	T50 - T250	.25" - 3" (6.35 - 76.2)	100 lb. (445)	.93" (23.6)	.8" (20.3)	.71" (18)	Black	50

Dimensions are approximate and subject to technical changes. Use **Part No.** for ordering and **Type** for specification purposes.

## Dual Swivel Saddle Spacer

### DSWS5

These saddle spacers are installed between two bundles (such as wires, cables, hoses, tubing, conduit, etc.) to separate them and prevent chafing and wear. The spacers can be easily rotated by hand, allowing the bundles to be crossed and rotated at any angle. Cable ties, which secure the bundles, are used with the spacers.

The DSWS5 accepts bundle diameters ranging from .625 inches to 6 inches. The DSWS5 provides a .93 inch (23.6 millimeter) separation between bundles. The dual swivel saddle spacers accommodate cable ties up to 1/2" wide.



Material Data	
Material	<b>Polyamide 6.6 heat stabilized (PA66HS)</b>
Operating Temperature	<b>-40 °F to +221 °F (-40 °C to +105 °C) continuous</b>
Flammability	<b>UL94 V2</b>

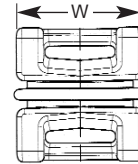
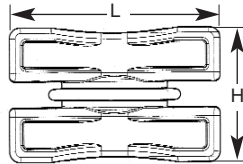
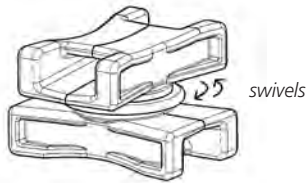

### Product Selection

Article No.	Part No.	Type	Cable Tie Series	Bundle Ø	Length (L)	Width (W)	Height (H)	Color	Pkg. Qty.
				in. (mm)	in. (mm)	in. (mm)	in. (mm)		
151-06502	<b>DSWS50HSK2</b>	DSWS5	T50 - T250	.625" - 6" (15.8 - 152.4)	1.6" (40.6)	1" (25.4)	.93" (23.6)	Black	50
151-06501	<b>DSWS50HSH1</b>	DSWS5	T50 - T250	.625" - 6" (15.8 - 152.4)	1.6" (40.6)	1" (25.4)	.93" (23.6)	Black	500

Dimensions are approximate and subject to technical changes. Use **Part No.** for ordering and **Type** for specification purposes.

## Bundle Separation Products

### Dual Clamp Ties

HellermannTyton's dual clamp ties are designed to provide parallel separation between hoses, wires, cables and tubing, protecting them from abrasion. These ties have an optional mounting hole for securing bundles along the chassis of trucks, trailers, and heavy duty equipment. The unique, one-piece design features the dual head centered on the strap.

Available in two lengths, the dual clamp ties accommodate bundles ranging from .25 inches to 2.3 inches. The flexible wide straps minimize pinching of hoses and convoluted tubing. The straps are also releasable.



U.S. Patent Number 5,966,781

Material Data	
Material	Polyamide 6.6 impact modified, Heat Stabilized, UV Resistant (PA66HIRHS)
Operating Temperature	-40 °F to +230 °F (-40 °C to +110 °C) continuous
Flammability	UL94 HB

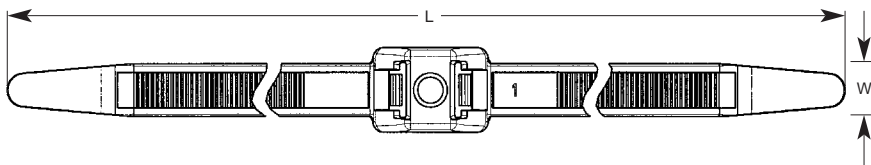

Product Selection			Stud Ø	Min. Tensile Strength	Length (L)	Max. Ø Bundle (each side)	Width (W)	Color	Pkg. Qty.
Article No.	Part No.	Type							
115-30900	<b>DCT90HIRK2</b>	DCT9	.25" (6.35)	150 lbs (670)	13.0" (331)	1.3" (33.02)	.50" (12.7)	Black	50
115-00034	<b>DCT90HIRC2</b>	DCT9	.25" (6.35)	150 lbs (670)	13.0" (331)	1.3" (33.02)	.50" (12.7)	Black	100
115-31100	<b>DCT110HIRK2</b>	DCT11	.25" (6.35)	150 lbs (670)	19.2" (489)	2.3" (58.42)	.50" (12.7)	Black	50
115-00033	<b>DCT110HIRC2</b>	DCT11	.25" (6.35)	150 lbs (670)	19.2" (489)	2.3" (58.42)	.50" (12.7)	Black	100

Installation tools - MK9, MK9HT, MK9P. Dimensions are approximate and subject to technical changes. Use **Part No.** for ordering and **Type** for specification purposes.

### Standoff Mounting Dual Clamp Ties

HellermannTyton's standoff dual clamp tie offers the same features as the standard dual clamp tie with a standoff mount that secures the bundle away from the side of the frame rail, protecting the bundles from bolts and other protrusions.

#### Features

- Wide strap minimizes pinching of soft hoses & convoluted tubing
- Clamping rails increase circumferential grip on varying bundle diameters
- Locking stud mount pawls allow for easy hand insertion
- Nut or weld nesting counterbore provides flush mounting at the base
- Socket counterbore for fastening a nut provides added retention



Material Data	
Material	<b>Polyamide 6.6 impact modified, Heat Stabilized, UV Resistant (PA66HIRHS)</b>
Operating Temperature	<b>-40 °F to +230 °F (-40 °C to +110 °C) continuous</b>
Flammability	<b>UL94 HB</b>

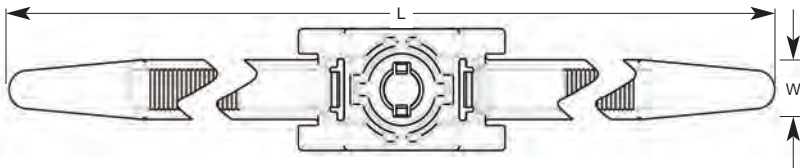

Product Selection			Stud Ø	Min. Tensile Strength	Length (L)	Max. Ø Bundle (each side)	Width (W)	Color	Pkg. Qty.
Article No.	Part No.	Type							
117-00012	<b>117-00012</b>	SDCTR312	.31" (7.94)	100 lbs (445)	20.1" (511)	2.3" (58.42)	.50" (12.7)	Black	250
157-00060	<b>157-00060</b>	SDCTL312	.31" (7.94)	100 lbs (445)	26.1" (663)	3.4" (86.36)	.50" (12.7)	Black	250

Installation tools - MK9, MK9HT, MK9P. Dimensions are approximate and subject to technical changes. Use **Part No.** for ordering and **Type** for specification purposes.

### Double Head Ties

Double head ties create two loops that separate two bundles. They can also be used to secure a bundle to an existing fixing point.

Material Data	
Material	<b>Polyamide 6.6 (PA66)</b>
Operating Temperature	<b>-40 °F to +185 °F (-40 °C to +85 °C)</b> <b>continuous</b>
Flammability	<b>UL94 V2</b>

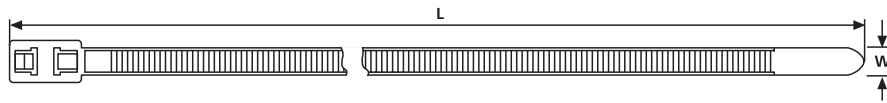

**UL**  
File# E64139

Product Selection		Type	Min. Tensile Strength		Length (L)		Width (W)		Color	Pkg. Qty.
Article No.	Part No.		lbs.	(N)	in.	(mm)	in.	(mm)		
<b>T50SDH</b>										
117-00016	<b>117-00016</b>	T50SDH	50 lbs	(225)	6.26"	(159)	.19"	(4.7)	Natural	100
117-00017	<b>117-00017</b>	T50SDH	50 lbs	(225)	6.26"	(159)	.19"	(4.7)		1000
117-00018	<b>117-00018</b>	T50SDH	50 lbs	(225)	6.26"	(159)	.19"	(4.7)	Black	100
117-00019	<b>117-00019</b>	T50SDH	50 lbs	(225)	6.26"	(159)	.19"	(4.7)		1000
<b>T50RDH</b>										
117-05006	<b>T50RDH9C2</b>	T50RDH	50 lbs	(225)	8.25"	(210)	.19"	(4.7)	Natural	100
117-05008	<b>T50RDH9M4</b>	T50RDH	50 lbs	(225)	8.25"	(210)	.19"	(4.7)		1000
117-05004	<b>T50RDH0C2</b>	T50RDH	50 lbs	(225)	8.25"	(210)	.19"	(4.7)	Black	100
117-05005	<b>T50RDH0M4</b>	T50RDH	50 lbs	(225)	8.25"	(210)	.19"	(4.7)		1000
<b>T50IDH</b>										
117-05302	<b>T50IDH9C2</b>	T50IDH	50 lbs	(225)	12"	(305)	.19"	(4.7)	Natural	100
117-05303	<b>T50IDH9M4</b>	T50IDH	50 lbs	(225)	12"	(305)	.19"	(4.7)		1000
117-05362	<b>T50IDH0C2</b>	T50IDH	50 lbs	(225)	12"	(305)	.19"	(4.7)	Black	100
117-05300	<b>T50IDH0M4</b>	T50IDH	50 lbs	(225)	12"	(305)	.19"	(4.7)		1000
<b>T50LDH</b>										
117-05402	<b>T50LDH9C2</b>	T50LDH	50 lbs	(225)	15.5"	(395)	.19"	(4.7)	Natural	100
117-05461	<b>T50LDH9M4</b>	T50LDH	50 lbs	(225)	15.5"	(395)	.19"	(4.7)		1000
117-05400	<b>T50LDH0C2</b>	T50LDH	50 lbs	(225)	15.5"	(395)	.19"	(4.7)	Black	100
117-05401	<b>T50LDH0M4</b>	T50LDH	50 lbs	(225)	15.5"	(395)	.19"	(4.7)		1000
<b>T120RDH</b>										
117-05501	<b>T120RDH0K2</b>	T120RDH	120 lbs	(535)	15.7"	(398)	.29"	(7.6)	Black	50
117-05500	<b>T120RDH0H4</b>	T120RDH	120 lbs	(535)	15.7"	(398)	.29"	(7.6)		500

Maximum bundle diameter is variable due to double loops. Installation tools - MK7, MK7HT, MK7P, MK9, MK9HT, MK9P. Dimensions are approximate and subject to technical changes. Use **Part No.** for ordering and **Type** for specification purposes.



### Pipe and Hose Clips, PC-Series

Pipe and hose clips offer simple and secure installation of pipes or hoses to panels. These clips can be attached to the panel prior to installing the pipe or hose. Simply push the pipe into the clip for a firm and secure fixing. These parts can be connected together offering a greater choice of installation options.



Material Data		RoHS
Material	<b>Polyamide 6.6 (PA66)</b>	
Operating Temperature	<b>-40 °F to +185 °F (-40 °C to +85 °C) continuous</b>	
Flammability	<b>UL94 V2</b>	

Material Data		RoHS
Material	<b>Polyamide 6.6 impact modified (PA66HIR)</b>	
Operating Temperature	<b>-40 °F to +176 °F (-40 °C to +80 °C) continuous</b>	
Flammability	<b>UL94 HB</b>	

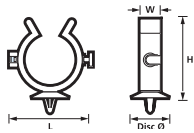

Product Selection											
Article No.	Part No.	Type	Height (H)	Width (W)	Disc Ø	Max. Ø Bundle	Mounting Hole Ø	Max. Panel Thickness	Material	Color	Pkg. Qty.
			in. (mm)	in. (mm)	in. (mm)	in. (mm)	in. (mm)	in. (mm)			
151-00096	<b>151-00096</b>	IPC10AH	.72" (18.4)	.39" (10)	.87" (22)	.49" (12.5)	.25" (6.3)	.06" (1.6)	PA66HIR	Black	100
151-14130	<b>151-14130</b>	IPC13AH	.83" (21)	.39" (10)	.87" (22)	.53" (13.5)	.25" (6.3)	.06" (1.6)	PA66	Black	100
151-14500	<b>151-14500</b>	IPC15AH	.91" (23)	.39" (10)	.87" (22)	.58" (14.7)	.25" (6.3)	.06" (1.6)	PA66HIR	Black	100
151-14601	<b>151-14601</b>	IPC23AH	1.3" (34)	.39" (10)	.87" (22)	.98" (25)	.25" (6.3)	.06" (1.6)	PA66	Black	100

Use **Part No.** for ordering and **Type** for specification purposes.

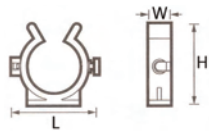

Product Selection								
Article No.	Part No.	Type	Height (H)	Width (W)	Max. Ø Bundle	Material	Color	Pkg. Qty.
			in. (mm)	in. (mm)	in. (mm)			
151-14400	<b>151-14400</b>	IPC10P	.59 (15)	.39 (10)	.49 (12.5)	PA66HIR	Black	100
151-14132	<b>151-14132</b>	IPC13P	.69 (17.4)	.39 (10)	.53 (13.5)	PA66	Black	100
151-14502	<b>151-14502</b>	IPC15P	.77 (19.5)	.39 (10)	.58 (14.7)	PA66HIR	Black	100
151-14603	<b>151-14603</b>	IPC23P	1.2 (30.5)	.39 (10)	.98 (25)	PA66	Black	100

Use **Part No.** for ordering and **Type** for specification purposes.

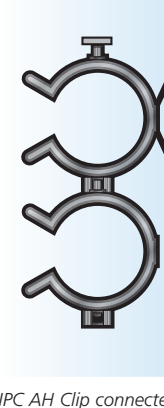

IPC AH Clip connected

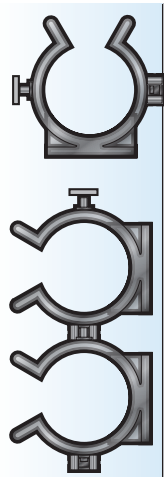

IPC P Clip connected

# Bundle Separation Products

## Automatic Harness Clips — Connectable

In addition to offering the same simple and secure method of attaching cables to panels as the non-connectable automatic harness clips, these products can be connected for additional installation flexibility.

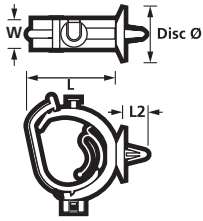

Material Data	
Material	Polyamide 6.6 impact modified, Heat Stabilized, UV Resistant (PA66HIRHS)
Operating Temperature	-40 °F to +230 °F (-40 °C to +110 °C) continuous
Flammability	UL94 HB



Product Selection												
Article No.	Part No.	Type	Length (L)	Length (L2)	Width (W)	Disc Ø	Max. Ø Bundle	Mounting Hole Ø	Panel Thickness in. (mm)		Color	Pkg. Qty.
			in. (mm)	in. (mm)	in. (mm)				in. (mm)	Min.		
151-00378	151-00378	IAHC3AH	1.5" (39)	.28" (7)	.39" (10)	.94" (24)	1.1" (28)	.24 - .26" (6.2 - 6.7)	.02" (.5)	.1" (2.7)	Black	500
151-00211	151-00211	IAHC4AH	1.8" (46)	.28" (7)	.51" (13)	.94" (24)	1.4" (36)	.24 - .26" (6.2 - 6.7)	.02" (.5)	.1" (2.5)	Black	450

Use **Part No.** for ordering and **Type** for specification purposes.



Product Selection							
Article No.	Part No.	Type	Length (L)	Width (W)	Max. Ø Bundle	Color	Pkg. Qty.
			in. (mm)	in. (mm)	in. (mm)		
151-00223	151-00223	IAHC1T	.91" (23)	.39" (10)	.51" (13)	Black	1300
151-00199	151-00199	IAHC2T	1.18" (30)	.39" (10)	.79" (20)	Black	700
151-00213	151-00213	IAHC3T	1.6" (40)	.39" (10)	1.1" (28)	Black	400
151-00207	151-00207	IAHC4T	1.9" (47)	.53" (13.5)	1.4" (36)	Black	1000
151-00195	151-00195	IAHC5T	2.24" (57)	.53" (13.5)	1.8" (45)	Black	700

Use **Part No.** for ordering and **Type** for specification purposes.



Elements AH and T connected.

## Automatic Harness Clips — Non-connectable

These clips offer a simple and secure method of attaching cables to panels. They can be attached to the panel prior to installing the cables. Simply pushing the cable into place closes the clip and activates the automatic locking feature.

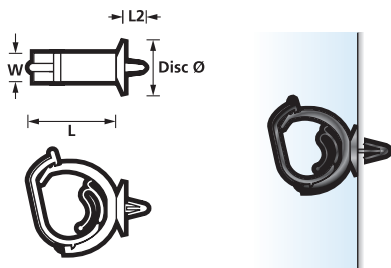

Material Data	
Material	<b>Polyamide 6.6 impact modified, Heat Stabilized, UV Resistant (PA66HIRHS)</b>
Operating Temperature	<b>-40 °F to +230 °F (-40 °C to +110 °C) continuous</b>
Flammability	<b>UL94 HB</b>



### Product Selection

Article No.	Part No.	Type	Length (L)	Length (L2)	Width (W)	Disc Ø	Max. Ø Bundle	Mounting Hole Ø	Min. Panel Thickness	Max. Panel Thickness	Color	Pkg. Qty.
			in. (mm)	in. (mm)	in. (mm)	in. (mm)	in. (mm)	in. (mm)	in. (mm)	in. (mm)		
151-00366	<b>151-00366</b>	AHC1AH	.98" (25)	.28" (7)	.39" (10)	.79" (20)	.51" (13)	.24 - .26" (6.2 - 6.7)	.02" (.5)	.08" (2)	Black	1500
151-00367	<b>151-00367</b>	AHC2AH	1.16" (29.5)	.28" (7)	.39" (10)	.79" (20)	.79" (20)	.24 - .26" (6.2 - 6.7)	.02" (.5)	.08" (2)	Black	900

Use **Part No.** for ordering and **Type** for specification purposes.

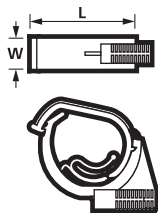

### Product Selection

Article No.	Part No.	Type	Length (L)	Width (W)	Max. Ø Bundle	Color	Pkg. Qty.
			in. (mm)	in. (mm)	in. (mm)		
151-00206	<b>151-00206</b>	AHC2SS	1.24" (31.5)	.39" (10)	.79" (20)	Black	1000

Use **Part No.** for ordering and **Type** for specification purposes.



## Bundle Separation Products

### Isolator

HellermannTyton's isolator mount is used to align and separate 1/4" tubing or brake lines. Easy to assemble, the isolator dampens vibrations and can be used with up to four brake lines. Mounting the isolator can be accomplished with HellermannTyton's standard cable ties, button head ties and any of HellermannTyton's heavy equipment mounts. Mounting is optional, but recommended for long runs. The isolator is durable, chemical and abrasion resistant, and remains flexible in low temperatures.



Material Data	
Material	<b>Thermoplastic Vulcanizate (TPV)</b>
Operating Temperature	<b>-50 °F to +329 °F (-45 °C to +200 °C)</b> <b>continuous</b>
Flammability	<b>UL94 HB</b>

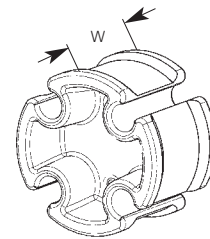

Product Selection				Max Bundle Ø	Mounting Ø	Overall Ø	Spacing Between Clips	Width (W)	Color	Pkg. Qty.
Article No.	Part No.	Type	Cable Tie Series							
151-00455	<b>ISO4X250H1</b>	ISO4X250	T50 - T250	.25" (6.4)	1.34" (34)	1.44" (36.6)	.51" (13)	.92" (23.4)	Black	500

Dimensions are approximate and subject to technical changes. Use **Part No.** for ordering and **Type** for specification purposes.

### Wire and Hose Swivel Clip Tie

This simple to use inside serrated tie provides the opportunity to attach an additional wire or hose to an existing harness. Offering a full 360 degrees of rotation, the wire/hose can be oriented in any direction in relation to the main harness. It is ideally suited for any application in which the wire or hose can move in relation to the mounting point.

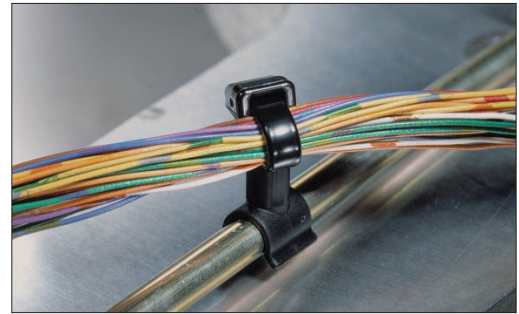

T50SVC rotates in any direction.

Material Data	
Material	<b>Polyamide 6.6 heat stabilized (PA66HS)</b>
Operating Temperature	<b>-40 °F to +221 °F (-40 °C to +105 °C) continuous</b>
Flammability	<b>UL94 V2</b>

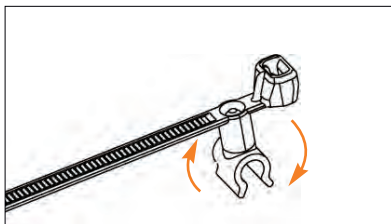

T50SVC

Product Selection			Tensile Strength	Hose Clip Ø	Maximum Bundle Ø	Length (L)	Width (W)	Color	Pkg. Qty.
Article No.	Part No.	Type	lbs (N)	in. (mm)	in. (mm)	in. (mm)	in. (mm)		
155-31202	<b>155-31202</b>	T50SVC	50 lbs (222)	.17" - .20" (4.5 - 5.2)	1.4" (35)	6.35" (163)	.18" (4.6)	Black	500

Installation tools - MK7, MK7HT, MK7P, MK9, MK9HT, MK9P.

Dimensions are approximate and subject to technical changes. Use **Part No.** for ordering and **Type** for specification purposes.

# Mounts

## Heavy Duty Mounts

The heavy duty mount, when used with a cable tie, eliminates the need to carry multiple sizes of fixed bundle diameter clamps, which reduces inventory and purchasing costs while simplifying the assembly process.

The heavy duty mount and cable tie combination makes it easy to service bundles in the field. Simply remove the cable tie, leave the mount in place, and replace the cable tie.

The heavy duty mounts are designed for use with HellermannTyton's heavy duty T250, T255, and wide strap cable ties to harness wires and hoses; however, they accept all standard cable ties up to .5" wide.

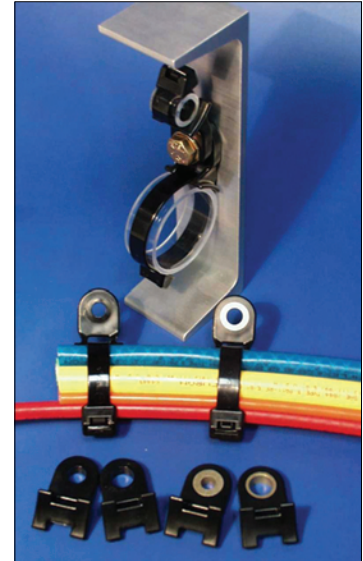

U.S. Patent Number 5,820,083

Material Data	
Material	<b>Polyamide 6.6 impact modified, Heat Stabilized, UV Resistant (PA66HIRHS)</b>
Operating Temperature	<b>-40 °F to +230 °F (-40 °C to +110 °C) continuous</b>
Flammability	<b>UL94 HB</b>



## Standard Torque Mounts

These mounts contain a small tab inside the mounting hole to temporarily engage the threads, which allows assemblers to pre-install the mount on a stud before securing with a washer and a nut.

Product Selection		Type	Mounting	Max Torque	Max Ø for Washer/Socket	Length (L)	Width (W)	Color	Pkg. Qty.
Article No.	Part No.		in. (mm)	lb. - in	in. (mm)	in. (mm)	in. (mm)		
151-00134	<b>HDM190HIRC2</b>	HDM19	.1875 (4.8)	115 lb. - in.	.73" (18.5)	1.43" (36.32)	.76" (19.3)	Black	100
151-00436	<b>HDM190HIRH4</b>	HDM19	.1875 (4.8)	115 lb. - in.	.73" (18.5)	1.43" (36.32)	.76" (19.3)	Black	500
151-00437	<b>HDM250HIRC2</b>	HDM25	.25" (6.4)	115 lb. - in.	.73" (18.5)	1.43" (36.32)	.76" (19.3)	Black	100
151-00438	<b>HDM250HIRH4</b>	HDM25	.25" (6.4)	115 lb. - in.	.73" (18.5)	1.43" (36.32)	.76" (19.3)	Black	500
151-00439	<b>HDM3120HIRC2</b>	HDM312	.3125" (8)	115 lb. - in.	.73" (18.5)	1.43" (36.32)	.76" (19.3)	Black	100
151-00440	<b>HDM3120HIRH4</b>	HDM312	.3125" (8)	115 lb. - in.	.73" (18.5)	1.43" (36.32)	.76" (19.3)	Black	500

Dimensions are approximate and subject to technical changes. Use **Part No.** for ordering and **Type** for specification purposes.

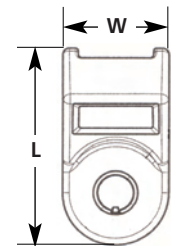

## Medium Torque Mounts

The arched "H" profile of the saddle surface allows for a broad surface contact with the bundle, minimizing pinching and crushing of the bundles, and adjusts to a wide variety of bundle diameters.

Product Selection		Type	Mounting	Max Torque	Max Ø for Washer/Socket	Length (L)	Width (W)	Color	Pkg. Qty.
Article No.	Part No.		in. (mm)	lb. - ft.	in. (mm)	in. (mm)	in. (mm)		
151-00441	<b>HDM321HIHSUVC2</b>	HDM321	.3125" (8)	40 lb. - ft.	.90" (23)	1.8" (46)	.96" (24)	Black	100
151-07100	<b>HDM321HIHSUVH4</b>	HDM321	.3125" (8)	40 lb. - ft.	.90" (23)	1.8" (46)	.96" (24)	Black	500
151-00442	<b>HDM401HIHSUVC2</b>	HDM401	.375" (9.5)	40 lb. - ft.	.90" (23)	1.8" (46)	.96" (24)	Black	100
151-07300	<b>HDM401HIHSUVH4</b>	HDM401	.375" (9.5)	40 lb. - ft.	.90" (23)	1.8" (46)	.96" (24)	Black	500
151-00443	<b>HDM501HIHSUVC2</b>	HDM501	.5" (12.7)	40 lb. - ft.	.90" (23)	1.8" (46)	.96" (24)	Black	100
151-07500	<b>HDM501HIHSUVH4</b>	HDM501	.5" (12.7)	40 lb. - ft.	.90" (23)	1.8" (46)	.96" (24)	Black	500

Dimensions are approximate and subject to technical changes. Use **Part No.** for ordering and **Type** for specification purposes.

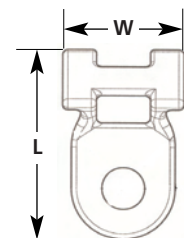

## Heavy Duty Mounts (continued)

### High Torque Mounts

The high torque mount is designed for use with power-assisted impact wrenches and is molded with a metal bushing to withstand the forces required to tighten grade 8 bolts. The arched "H" profile of the saddle surface allows for a broad surface contact with the bundle, minimizing pinching and crushing of bundles, and it adjusts to a wide variety of bundle diameters.

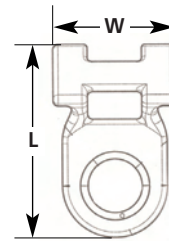

Product Selection									
Article No.	Part No.	Type	Mounting	Max Torque	Max Ø for Washer/Socket	Length (L)	Width (W)	Color	Pkg. Qty.
			in. (mm)	lb. - ft.	in. (mm)	in. (mm)	in. (mm)		
151-00444 151-07000	<b>HDM320BHIHSUVC2</b> <b>HDM320BHIHSUVH4</b>	HDM320 HDM320	.3125" (8) .3125" (8)	114 lb. - ft. 114 lb. - ft.	.9" (23) .9" (23)	1.85" (47) 1.85" (47)	.99" (25) .99" (25)	Black Black	100 500
151-00445 151-07200	<b>HDM400BHISHUVC2</b> <b>HDM400BHIHSUVH4</b>	HDM400 HDM400	.375" (9.5) .375" (9.5)	114 lb. - ft. 114 lb. - ft.	1.26" (32) 1.26" (32)	1.85" (47) 1.85" (47)	.99" (25) .99" (25)	Black Black	100 500
151-00446 151-07400	<b>HDM500BHIHSUVC2</b> <b>HDM500BHIHSUVH4</b>	HDM500 HDM500	.5" (12.7) .5" (12.7)	114 lb. - ft. 114 lb. - ft.	1.26" (32) 1.26" (32)	1.85" (47) 1.85" (47)	.99" (25) .99" (25)	Black Black	100 500

Dimensions are approximate and subject to technical changes. Use **Part No.** for ordering and **Type** for specification purposes.

### High Torque Double Mount

This mount is designed for use with power-assisted impact wrenches and is molded with a metal bushing to withstand the forces required to tighten grade 8 bolts. The high torque double mount secures the bundle directly over the mounting fastener. The cable ties are held in place during assembly with friction tabs inside the cable tie slots. The arched "H" profile of the saddle surface allows for a broad surface contact with the bundle, minimizing pinching and crushing of the bundles, and accommodates a wide variety of bundle diameters.

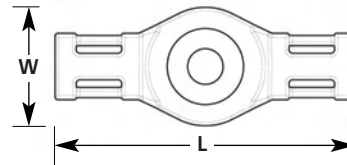

Product Selection									
Article No.	Part No.	Type	Mounting	Max Torque	Max Ø for Washer/Socket	Length (L)	Width (W)	Color	Pkg. Qty.
			in. (mm)	lb. - ft.	in. (mm)	in. (mm)	in. (mm)		
151-00456	<b>151-00456</b>	HDM375	.375" (9.5)	114 lb. - ft.	1.27" (32.5)	3.43" (87)	1.36" (34.5)	Black	100

Dimensions are approximate and subject to technical changes. Use **Part No.** for ordering and **Type** for specification purposes.