

# PRODUCT DATA DRAWING

| REVISION HISTORY |                |          |          |
|------------------|----------------|----------|----------|
| REV              | DESCRIPTION    | DATE     | APPROVED |
| -                | PRELIMINARY    | 09/13/07 | JM       |
| A                | REL. NRN 34347 | 09/27/07 | STW      |
| B                | DCN 35853      | 06/08    | STW      |

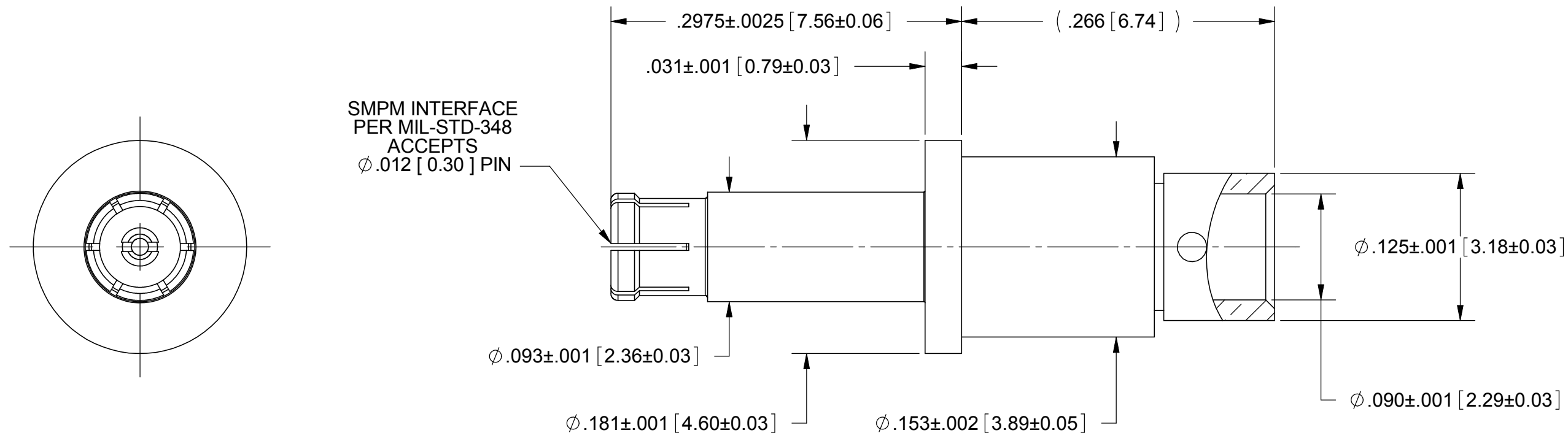

**MATERIAL:**

- BODY & CONTACT:** BERYLLIUM COPPER PER ASTM B196, ALLOY No. UNS C17300, TD04.
- INSERT:** BRASS PER ASTM B16, ALLOY No. UNS 36000
- INSULATOR:** PTFE PER ASTM D1710, TYPE I, GRADE 1, CLASS B

**FINISH:**

- BODY, INSERT & CONTACT:** GOLD PER ASTM B488, TYPE II, CODE C, CLASS 1.27; OVER NICKEL PER AMS-QQ-N-290, CLASS 1, .00005" MIN.

**PERFORMANCE:**

- IMPEDANCE:** 50 OHMS
- FREQ. RANGE:** DC TO 65.0 GHz
- DWV:** 325 VRMS
- OPERATING TEMP.:** -55°C TO +125°C
- VSWR:** 1.10:1 DC TO 26.5GHz, 1.30:1 TYPICAL TO 50 GHz
- INSERTION LOSS:** .12 X SQRT(F(F IN GHz))
- INSUL. RESISTANCE:** 5000 MEGOHMS MIN.
- CONTACT RESISTANCE:**
- OUTER CONDUCTOR:** 2 MILLIOHMS MAX.
- INNER CONDUCTOR:** 6 MILLIOHMS MAX.

## PIN CONTACT

|                            |  |  |   |
|----------------------------|--|--|---|
| <b>MATERIAL:</b> SEE NOTES | <b>DIMENSIONS ARE IN INCHES TOLERANCES:</b><br>FRACTIONAL: ±1/64 ANGULAR: X° ±1'0"<br>X"X' ±15'  | <b>UNLESS OTHERWISE SPECIFIED</b><br>1) ALL DIMENSIONS ARE IN INCHES (MILLIMETERS)<br>2) ALL DIMENSIONS ARE AFTER PLATING<br>3) BREAK CORNERS & EDGES .005 R. MAX.<br>4) CHAM. 1ST & LAST THREADS.<br>5) SURFACE ROUGHNESS 63-MIL-STD-10.<br>6) DIA. 'S ON COMMON CENTERS TO BE CONCENTRIC WITHIN .005 T.I.R.<br>7) REMOVE ALL BURRS | <b>SV Microwave, Inc.</b><br>2400 Centrepark West Drive, Suite 100<br>West Palm Beach, FL 33409 |
| <b>FINISH:</b> SEE NOTES   | DECIMAL: X ±.030<br>.XX ±.010<br>.XXX ±.005  | INTERPRET DIMENSIONS AND TOLERANCES PER ASME Y14.5M - 1994   | <b>TITLE:</b><br>SMPM FEMALE T-FLEX 405 CABLE<br>FIT M38999 SIZE 12 INSERT                      |
| <b>SURFACE AREA:</b> N/A   | <b>PROPRIETARY</b><br>THE INFORMATION CONTAINED IN THIS DRAWING IS THE SOLE PROPERTY OF SV MICROWAVE, INC. ANY REPRODUCTION IN PART OR AS A WHOLE WITHOUT THE WRITTEN PERMISSION OF SV MICROWAVE, INC IS PROHIBITED. | <b>THIRD ANGLE PROJECTION</b><br>  | <b>SIZE:</b> B <b>CAGE CODE:</b> 95077 <b>DWG. NO.:</b> 3221-4002                               |
|                            |  | <b>DRAWN:</b> JMC 09/13/07<br><b>CHECKED:</b> JM 09/13/07<br><b>APPROVED:</b> JM 09/13/07  | <b>SCALE:</b> 10:1 <b>SHEET 1 OF 1</b>  |